

BCA1000 Series AC Battery Charger

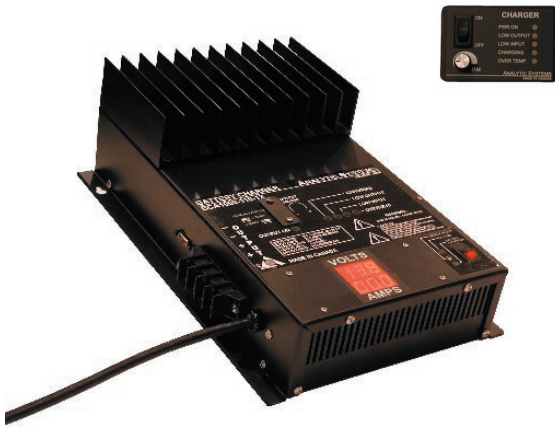

(Shown with Optional Digital Meter)

A product of:



Benefits

- Ultra-Quiet
- Power sensitive electronics without interference
- Rugged & Reliable
- Ensure years of safe and trouble free operation
- Fast & Accurate Charging

Applications

- Marine & other Rugged Environments
- Automotive / RV
- Electric Utilities and Substations
- Base Station Power (Radio & Telecommunications)
- OEM Applications
- Field Work / Construction Sites
- Solar Power Systems
- Emergency Power Backup (UPS)
- Security Systems
- Charge any 12, 24, 32, or 48 Volt Battery System

Battery Chargers

BCA1000 Series

Description

The BCA1000 battery charger provides up to 1000 watts to charge a 12, 24, 32, or 48 Volt battery system (1, 2 or 3 banks) from a 110 or 230VAC source. The batteries must share a common ground.

This all-new single board design incorporates state of the art switchmode technology for unmatched efficiency and ultra-quiet operation. Multiple stages of filtering reduce radiated or conducted noise to very low levels. Extra features include adjustable output voltage, audible and visual indicators for low input voltage, low output voltage, over temperature and an equalize charging cycle. Safety features include both charger and battery over-temperature shutdown, current limiting, short circuit protection with automatic recovery, input undervoltage shutdown, reverse battery hook-up protection, a dry contact alarm relay output and output overvoltage crowbar.

Optional features include a Digital Volt/Ammeter, 3-Bank Charging, a Remote Control Panel, and/or a second Battery Temperature Sensor. We are confident that you will get many years of reliable service from this AC Battery Charger.

Features

- Ideal as Global Marine Distress Safety System (GMDSS) power supply when equipped with optional voltmeter and ammeter.
- Adjustable output voltage for charging standard or deep cycle lead-acid, VRLA or Gel cell type battery
- Temperature compensated charging
- High tolerance for shock and vibration
- Ultra-quiet low EMI operation
- Can be left permanently connected
- Can function as a power supply
- User selectable 2 or 3 stage charging profile
- 3 Bank Option Available
- Audible & visual indicators for output overload, low input voltage, low output voltage & over-temperature
- Over-temperature shutdown
- Short circuit protection
- Output over-voltage crowbar
- Inrush Current Limiting with solid state bypass
- Dry contact output fail relay
- Thermostatically controlled fan
- 3 year parts and labour warranty

Mechanical Diagram

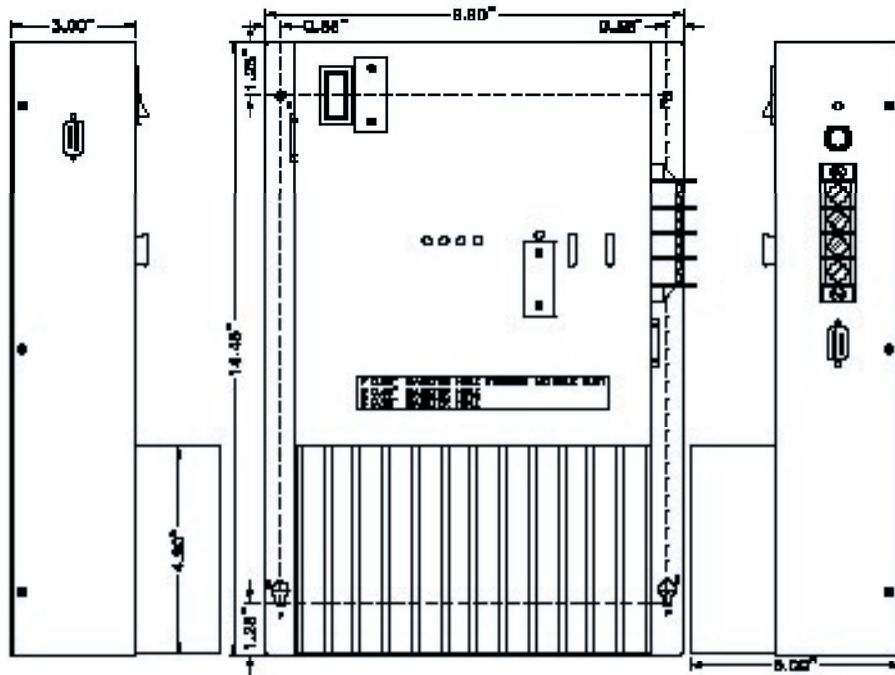

Specifications (Specifications Subject to Change Without Notice)

Electrical (Input)

Nominal Vac (ip)	110	230
Actual (Vac)	105-125	210-250
Input Amps (max)	14.6	7.3
Input Fuse (MDA)	20A/ 15A(12V)	10A/ 8A(12V)
Input Frequency	45-65 Hz	
Noise on Input	< 50 mV	

Environmental Specifications

Operating Temp. Range	-25° to +40°C @ maximum output Derate Linearly 2.5% per °C from 40°C (Optional -40°C extra wide-temp. operation avail.)
Humidity	0 - 95% Relative Humidity (non-condensing) with optional conformal coating
Audible Noise	NONE Ødb @ 3 ft
Typical Service Life	> 10 yrs. (87,600 hrs)
Isolation	Input-Case & Input-Output 1500VDC Output-Case 500VDC (1500V @ 48V Output)

Electrical (Output)

Output Nominal (op)	12	24	32	48
Output Volts (DC)	13.6 ± 0.05	27.2 ± 0.05	36.3 ± 0.05	54.4 ± 0.05
Absorption Voltage (Vdc)	14.4	28.8	38.4	57.6
Charging Amps	60	40	30	20
Absorption to Float (15%)	9 Amps	6 Amps	4.5 Amps	3.0 Amps
Output Adjustment (Vdc)	± 1V			
Output Fuses (ATC)	40 x 2	40 x 2	40 x 2	30 x 2
Battery Banks	1 or 2 (3 Bank Option Available)			
Output Crowbar	16.0 ± 0.5V	32.0 ± 1.0V	42.7 ± 1.3V	63.9 ± 2.0V
Battery Size (Amp Hrs.)	240 – 360	160 – 240	120 – 180	80 – 120
Output Ripple & Noise	< 50 mV			
Regulation (Line & Load)	< +/- 0.5%			
Temperature Comp.	-30 mV/°C	-60 mV/°C	-80 mV/°C	-120 mV/°C
Duty Cycle	Continuous 100% for 24 hours per day			
Efficiency	> 75% @ Maximum Output			
Stages	2 or 3 (user selectable)			

Mechanical Specifications

Length	14.5 in / 36.8 cm
Width	9.9 in / 25.1 cm
Height	5.5 in / 14.0 cm
Clearance	1 inch (2.5 cm) all around
Material	Marine Grade Aluminium
Finish	Black Anodize / Powder Epoxy Coat
Fastenings	All 18-8 Stainless Steel
Weight	12.0 lb / 5.5 kg
Connections	Four contact output terminal
Warranty	3 years
Safety	Fully Certified to UL458 & CSA22.2.107.1

Available from:

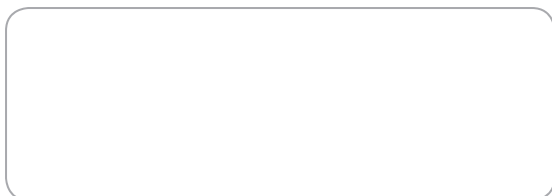

RIPEnergy®

The power conversion company

RIPEnergy AG
Wägitalstrasse 24
CH-8854 Siebnen
Switzerland

Ph +41-(0)43-818 53 85
Fax +41-(0)43-818 53 87
www.ripenergy.ch